

We reside in densely populated cities surrounded by functional buildings that prioritise efficiency. While these structures offer convenience, they separate us from nature, making appreciating natural surroundings a luxury. The absence of nature in modern cities has inspired Ma Yansong and MAD Architects to incorporate natural spirit into their designs.

After visiting the exhibition, have you observed the integration of daily life and nature elements in Ma Yansong's works? Has this sparked your interest in architectural design and made it more captivating? Or do you still consider it a profound and challenging field?



Let's delve into the **Four Key Aspects** of Ma's creations. Through the upcoming content and engaging activity, let us approach his nature-inspired spirit from an alternative perspective. Collectively, we can **initial stage of designing and manifesting your very own building!**

1 NATURAL INTEGRATION

Incorporating natural elements of the environment into the design to create a space that is harmonised with the community

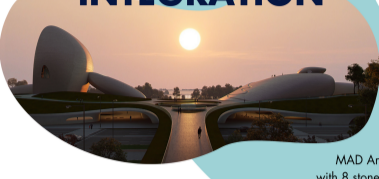

Shenzhen Bay Cultural Plaza

Shenzhen, China

MAD Architects created the Shenzhen Bay Cultural Plaza with 8 stone-shaped buildings, like a group of stones leaning against each other in the Houhai Bay of Shenzhen.

Are there any natural landscapes near your building, for example, the sea, hills, or stone walls?

If you were to integrate this building with the natural landscape, what form would you choose?



2 RESPECT FOR CULTURE AND HISTORY

Integrating local tradition and cultural elements into the design to showcase local characteristics and identity



Yuecheng Courtyard Kindergarten

Beijing, China

The 300-year-old courtyard house is preserved and surrounded by a colorful new kindergarten, creating an environment where the old and the new coexist. The new building uses the red, orange, and yellow colors unique to the Forbidden City in Beijing as the main colors to show the local characteristics.



What do you think are the characteristics of Hong Kong? Are there any cultural elements that represent this place?



3 REVOLUTIONISING TRADITION

By pursuing architectural innovation, MAD Architects challenge the boundaries of traditional design standards, aiming to create truly forward-thinking structures in tune with the contemporary world

Absolute Towers

Mississauga, Canada

MAD challenges conventional architectural specifications with their unconventional design. Resembling the twisting curves of a woman's torso, this striking skyscraper has earned itself the nickname "Marilyn Monroe Building".



Instead of limiting yourself to existing possibilities, envision a groundbreaking and innovative architectural form. Let your imagination soar beyond the confines of tradition!

4 ORGANIC FORM

Applying curves, irregular shapes, and flowing lines in the creation of dynamic and distinctive architectural structures

Lucas Museum of Narrative Art

Los Angeles, USA

The design of the museum features smooth, organic lines that evoke a futuristic aesthetic. Its appearance can be likened to that of a futuristic battleship gracefully descending upon a park, seamlessly harmonising with the surrounding natural environment.

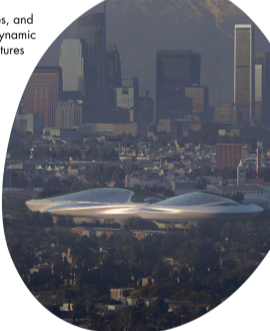

Let's use your imagination and sensibility to express your emotions and put them into your work!



What do you consider the most crucial aspect of architectural design?

Skill, experience, or professional knowledge?

In this exhibition, Ma Yansong highlights the

Significance of Empathy and Imagination.

He asserts that architecture, as a kind of human creation, is an extension of the inner world of humanity, reflecting our attitudes towards the world, history, and the future.

Consequently, architectural works should possess a **Human Touch**

He believes that designs infused with humanistic sentiments can evoke empathy in others, regardless of the passage of time.

Did you know that architects must learn the art of sketching?

This is because they often need to visualise the ideas in their minds, making them a group of skilled sketchers!

One popular sketching style in the field of design and architecture is known as **Line Drawing**

It utilizes **Simple, Clean lines** without shading or color, and

Ma frequently uses this style to initiate his grand ideas with simplicity and spontaneity.

Let's create the building in your mind!

Now, using the line drawing style, let's select an element such as an object, person, animal, natural landscape, or even an imaginary creature from beyond Earth. Feel free to refer to the focal points and guiding questions mentioned earlier to stimulate your creative ideas.

With this element in mind, let's attempt to sketch the initial draft of **Your Building!**

